



LAUNCHING 20th SEPTEMBER – Attend the launch and get your Stamp Duty Paid* when you reserve your home before October 1st 2025.

The Kennet is a thoughtfully designed two-bedroom home that blends style and practicality. At the front of the home, the modern kitchen offers a bright and functional space. To the rear, the open-plan living and dining area provides a perfect setting for relaxing or entertaining, with elegant French doors leading directly onto the private rear garden. Upstairs, you'll find two generously sized bedrooms and a contemporary family bathroom, making The Kennet an ideal home for first-time buyers, downsizers, or those seeking a low-maintenance lifestyle.

*T&Cs apply. Please speak with a sales advisor for more information.

Interested? Please contact our New Homes team to find out more, or to book a viewing.

newhomes@haslams.net
0118 960 1010



- Attractive 2 bedroom house with two parking spaces
- Peaceful lakeside setting
- Blossoming new community
- Convenient location near schools, shops, leisure facilities and town centre
- Excellent transport links with Theale Station and the M4 close by
- Countryside walks and rural tranquillity with strong connectivity





Further details

Council tax band New Build

Agent notes

Estimated build completion Autumn 2025

Estate fee: TBC

Reservation Fee: Please note that to secure an offer on this property, you will be required to pay a fee of £1,000. For specific terms, please contact our office.

Please note some images are CGIs and are to be used as a guide only.

Floorplan

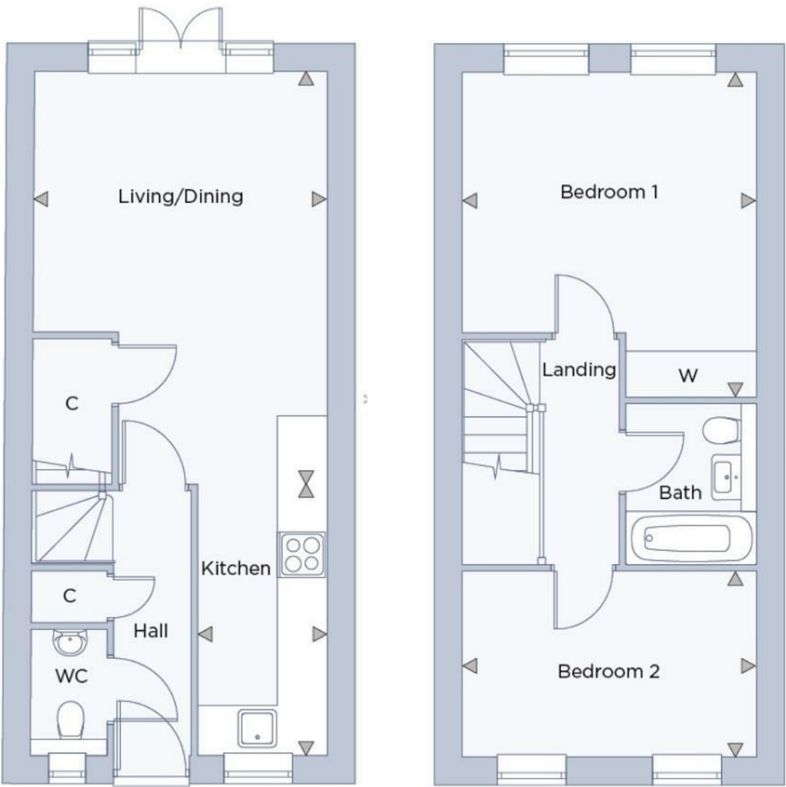

Ground Floor Room	Dimensions (feet & inches)
Living/ dining	17'10" x 12'8"
Kitchen	11'0" x 5'7"

First Floor Room	Dimensions (feet & inches)
Bedroom 1	13'2" x 10'1"
Bedroom 2	11'0" x 11'0"
Bathroom	12'0" x 8'6"



Please contact our New Homes team to find out more, or to book a viewing.

newhomes@haslams.net
0118 960 1010

The specifications outlined in this brochure are indicative only. Developers reserve the right to make any alterations to the specifications without warning. Whilst these particulars are prepared with all due care, the information is intended as a preliminary guide only. The computer generated images and photographs do not necessarily represent the actual finishings/elevation or treatments, furnishings and fittings at this development. Room measurements are approximate only. Floor plans, dimensions and specifications are correct at the time of print. Nothing contained in this brochure shall constitute or form part of any contract. Information contained in this brochure is accurate at the time of going to print.